

GENERAL NOTES:
 -USE MIN. #2 GRADE SPF LUMBER
 -USE STAINLESS STEEL SCREWS IN CCA LUMBER
 -USE CCA LUMBER AT ALL GROUND/SLAB CONTACT POINTS
 -PAINT OR WRAP ALL EXPOSED LUMBER
 -USE PAINTED ALUM. SCREWS FOR ROOFING/SIDING ATTACHMENT AT MAX. 16' SPACING

STRUCTURAL DESIGN DATA		
MISC.	CONCRETE STRENGTH (PSI@28 DAYS)	3500
	SOIL BEARING CAPACITY (PSF)	2000
DECK LIVE LOAD	UNIFORMLY DISTRIBUTED (PSF)	125
	CONCENTRATED (LBS)	500
	IMPACT	---
	REDUCTION	---
DECK LIVE LOAD (PSF)		22
DECK SNOW LOAD	GROUND SNOW LOAD (Pg)	25
	FLAT-ROOF SNOW LOAD (Pf)	22
	SNOW EXPOSURE FACTOR (Ce)	.9
	SNOW LOAD IMPORTANCE FACTOR (I _s)	1.0
WIND LOAD	THERMAL FACTOR (C _t)	1.0
	BASIC WIND SPEED (MPH)	90
	WIND IMPORTANCE FACTOR (I)	1.0
	BUILDING CATEGORY	I
	WIND EXPOSURE	C
	INTERNAL PRESSURE COEFFICIENT	.18
	COMPONENTS AND CLADDING DESIGN WIND PRESSURE (PSF)	20
EARTHQUAKE DESIGN DATA	SEISMIC CLASSIFICATION/IMPORTANCE FACTOR	I/1.0
	SPECTRAL RESPONSE COEFFICIENTS	S _{rs} .20 S _{rs} .13
	SITE CLASS	0
	BASIC SEISMIC FORCE-RESISTING SYSTEM	IL
	DESIGN BASE SHEAR	.174W
	ANALYSIS PROCEDURE	SIMPLIFIED
FLOOD LOAD	LOCATED IN FLOOD-HAZARD AREA?	NO
	HIGH-VELOCITY WAVE ACTION?	LOWEST HORIZONTAL STRUCTURAL MEMBER ELEVATION ---
SEISMIC DESIGN CATEGORY	NON-HIGH-VELOCITY WAVE ACTION?	LOWEST FLOOR ELEVATION DRY FLOODPROOFED ELEVATION ---
		B

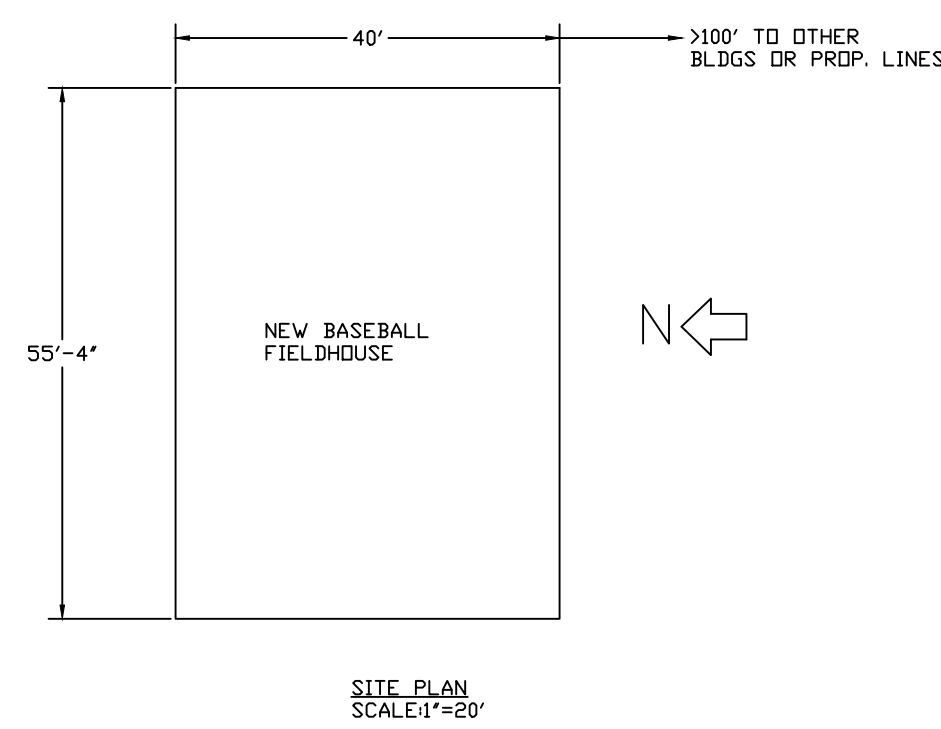

BRECH
 ENGINEERING
 * 1828 EASTERN AVE. * GALLIPOLIS, OHIO 45631 *
 * (740) 446-0059 VOICE * (740) 446-1889 FAX *

DESIGNED BY	BRIDGIT HARRIS
CHECKED BY	EG BRECH, P.E.
SCALE	AS NOTED
DATE	08/16/12

UNIVERSITY OF RIO GRANDE
 BASEBALL FIELDHOUSE
 RIO GRANDE, OHIO