

McGill Smith Punshon, Inc.
 3700 Park 42 Drive Suite 190B
 Cincinnati, Ohio 45241-2097
 Tel. 513-759-0004 • Fax 513-563-7099
 Engineers • Architects • Surveyors
 Planners • Landscape Architects

Drawn By CJA Project Mgr. NSD

CAD File
 X-Ref File

Issue/Revision	Revision Number	Date
BID SET		11/16/15

© COPYRIGHT 2015, MCGILL SMITH PUNSHON, INC.

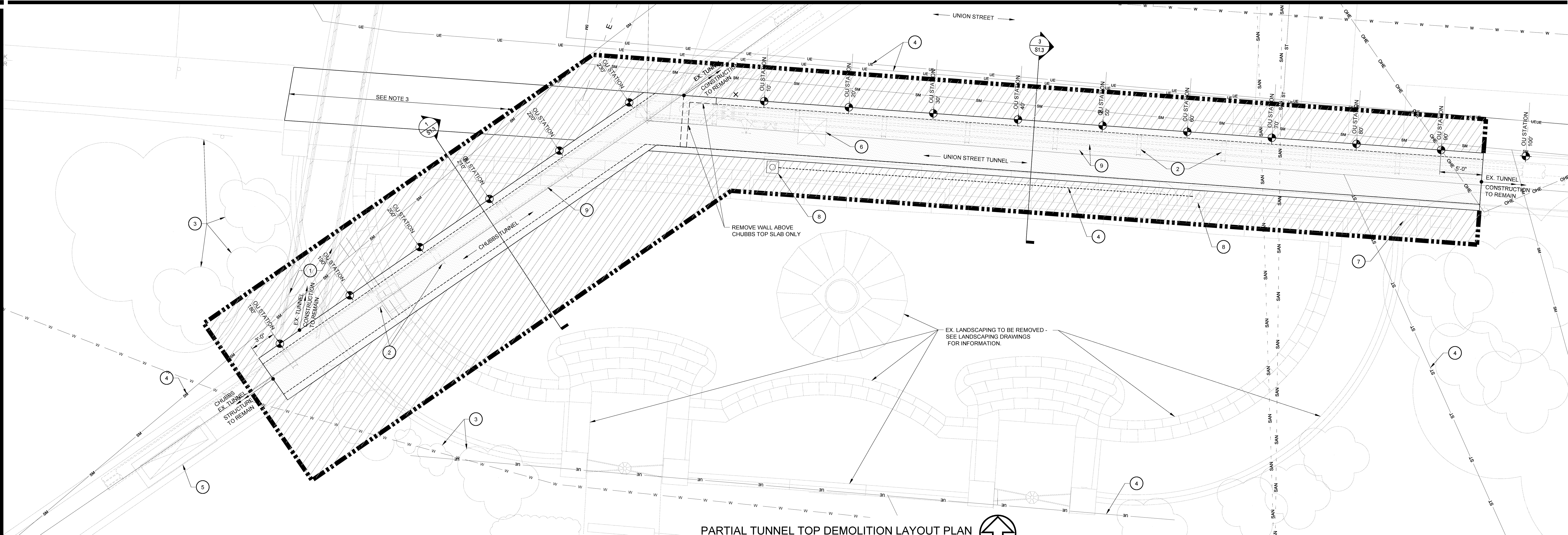

PARTIAL TUNNEL TOP DEMOLITION LAYOUT PLAN
 1"=5'-0"

- NOTES:**
- OU STATIONS ARE LOCATED INSIDE THE TUNNEL AND ARE INCLUDED FOR REFERENCE ONLY.
 - ALL UTILITIES BETWEEN TUNNEL TOP AND SIDEWALKS/ GROUND SURFACE TO BE PROTECTED. SEE NOTE D ON SHEET S1.3.
 - EXISTING CONCRETE SIDEWALK TO BE REMOVED AND REPLACED IN THIS AREA. COORDINATE WITH LANDSCAPING DRAWINGS FOR ADDITIONAL INFORMATION.

- LEGEND:**
- INDICATES EXTENTS OF TUNNEL TOP REMOVAL.
 - INDICATES APPROXIMATE EXTENTS OF EXCAVATION.

CODED NOTES: (COMMON TO PLAN AND PROFILE)

- EXISTING CROSS TUNNEL STRUCTURE TO REMAIN IN PLACE. TUNNEL STRUCTURE SHALL BE LOCATED PRIOR TO INSTALLATION OF EARTHWORK SHORING AND SHALL REMAIN PROTECTED DURING THE ENTIRE CONSTRUCTION PHASE.
- EXISTING STEEL FRAMES, SUPPORTING HVAC PIPING, TO BE REMOVED - ONLY AFTER NEW STEEL FRAMES ARE INSTALLED AND THE EXISTING HVAC PIPING HAS BEEN SUPPORTED ON THE NEW STEEL FRAMES. EXISTING STEEL FRAMES SHALL BE SUPPORTED Laterally, PRIOR TO REMOVING THE TUNNEL TOP SLAB. TEMPORARY LATERAL BRACING SHALL REMAIN IN PLACE UNTIL NEW FRAMES ARE INSTALLED IN PLACE AND NEW HVAC PIPING HAS BEEN SUPPORTED ON THE NEW STEEL FRAMES. CONTRACTOR SHALL REMOVE 3' PORTION OF EXISTING PIPING INSULATION AROUND EACH PIPE AT EACH EXISTING PIPE SUPPORT FRAME TO ALLOW FOR INSTALLATION OF NEW PIPE SUPPORT FRAME AND PIPE SUPPORTS.
- EXISTING TREES AND LANDSCAPING FEATURES BEYOND THE PROJECT LIMITS SHALL BE PROTECTED DURING THE ENTIRE TUNNEL TOP REPLACEMENT PHASE. SEE LANDSCAPING DRAWINGS FOR ADDITIONAL INFORMATION.
- EXISTING SANITARY PIPING AND ALL BURIED UTILITIES SHALL BE PROTECTED DURING THE TUNNEL TOP REPLACEMENT PHASE. SEE LANDSCAPING PLANS FOR APPROXIMATE LAYOUT OF EXISTING UTILITIES. ALSO SEE NOTE D ON DRAWING S1.3.
- EXISTING TUNNEL VENT STRUCTURE TO REMAIN IN PLACE.
- EXISTING TUNNEL ACCESS STRUCTURE AND METAL LADDER ASSEMBLY TO BE REMOVED AND REPLACED. SEE DRAWINGS S1.2 & FOR ADDITIONAL INFORMATION.
- EXISTING BRICK FACED PIER AND FOUNDATION TO BE REMOVED - SEE LANDSCAPING DRAWINGS FOR ADDITIONAL INFORMATION.

- EXISTING TRAFFIC LIGHT AND FOUNDATION SHALL BE PROTECTED DURING CONSTRUCTION PHASE. SEE LANDSCAPING DRAWINGS FOR ADDITIONAL INFORMATION.
- EXISTING HVAC PIPING - SEE NOTE B ON DRAWING S1.3.

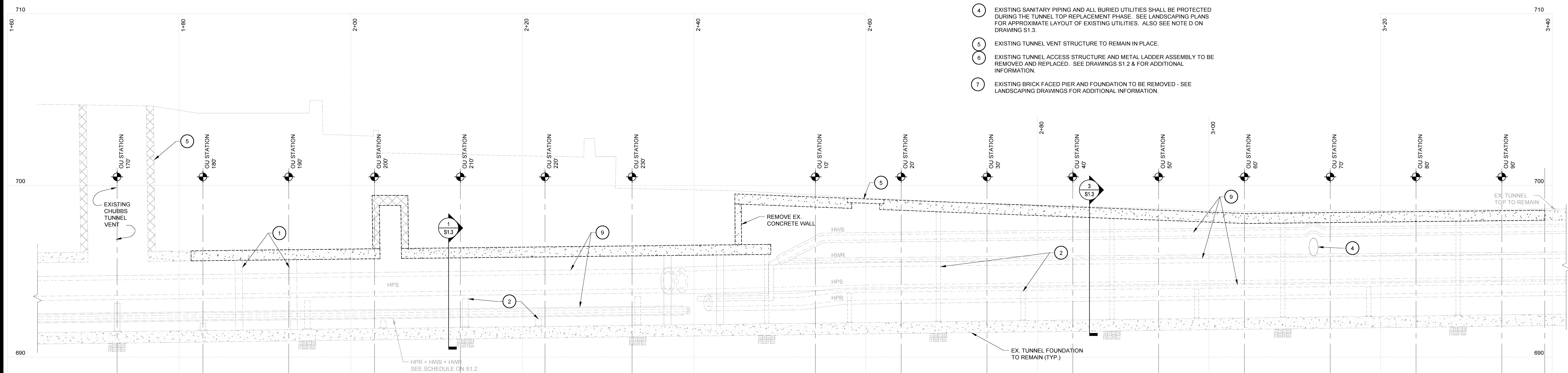

PARTIAL TUNNEL TOP DEMOLITION PROFILE
 1"=5'-0" (HORIZONTAL SCALE)
 1"=2'-0" (VERTICAL SCALE)

- LEGEND:**
- INDICATES EXTENTS OF TUNNEL TOP REMOVAL.
 - INDICATES EXISTING 'ABANDONED' TUNNEL ACCESS STRUCTURE TO BE REMOVED.



BARBER & HOFFMAN, INC.
 Consulting Engineers
 8720 Orion Place, Suite 380
 Columbus, OH 43240
 614-825-9580
 barberhoffman.com

CONTRACTOR TO FIELD VERIFY EXISTING CONDITIONS & DIMENSIONS IN THE FIELD

**COLLEGE GREEN UPGRADE
 CLASS GATE AND TUNNEL
 OHIO UNIVERSITY**
 ATHENS, OHIO 45701
 ATHENS COUNTY, OHIO

Sheet Title
 TUNNEL TOP DEMOLITION PLAN
 AND PROFILE

Project No. 13412.00

Scale AS NOTED

Sheet No. S1.1

File No. 13-412